

Instruction Sheet

Thermo Scientific Orion Star A Series Benchtop Meter-Attachable Electrode Stand

This instruction sheet provides general assembly instructions for the Thermo Scientific™ Orion Star™ A series benchtop meter-attachable electrode stand, Catalog Number STARA-BEA, with the Thermo Scientific™ Orion™ Versa Star™ benchtop meters, Thermo Scientific™ Orion™ Dual Star™ benchtop meters (redesigned version only), Orion Star A210 series benchtop meters and Orion Star A110 series benchtop meters. For complete meter setup and operation instructions, consult the appropriate meter user manual, available at www.thermoscientific.com/OrionMeters.

Product: STARA-BEA
Revision Date: October 20, 2015
IS-STARA-BEA-E Revision A

Product Information

Use the Orion Star A series benchtop meter-attachable electrode stand to easily place electrodes and probes in samples, simplify rinsing and storage between samples and minimize electrode breakage using the stand's cable management system. The electrode stand can be attached to either side of the meter and up to two stands can be attached to each meter. Alternatively, the stand can be used with the weighted base for compatibility with any meter system. The weighted base (Catalog Number STARA-HB) must be purchased separately.

The Orion Star A series benchtop meter-attachable electrode stand includes the meter bracket (base plate), electrode arm and electrode holder. The electrode holder can also be ordered separately using Catalog Number STARA-ELHD.

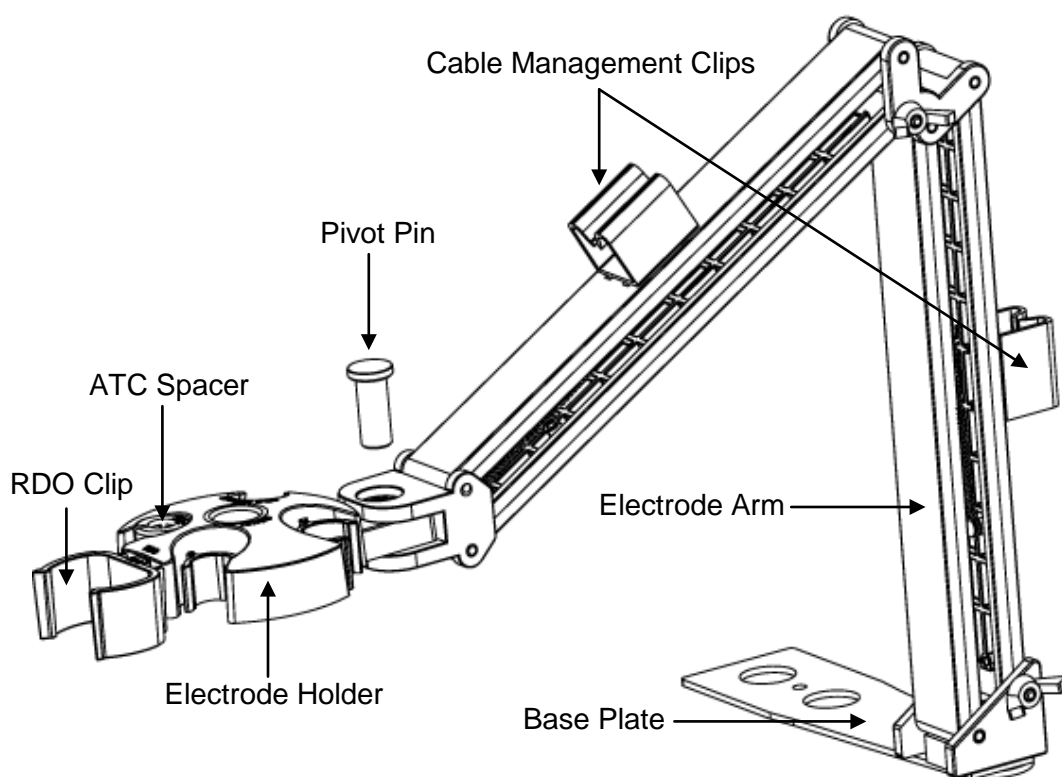

Figure 1:

Assembly Procedure for the Electrode Stand

1. Open the box containing the electrode stand. The box will include a base plate, electrode arm, pivot pin, electrode holder, ATC spacer and RDO clip. See *Figure 1*.
2. Turn the meter over, with the meter display facing down, on a clean dry surface.
3. Identify the side of the meter that the stand will be installed on and remove the screw between the circles on that side of the meter.
4. Align the base plate of the stand with the circles on the meter.
5. Replace the screw from step 3 to attach the base plate to the meter.

6. Turn the meter over, with the meter display facing up.
7. Insert the electrode arm into the metal post on the base plate.
8. Connect the electrode holder to the electrode arm using the pivot pin.

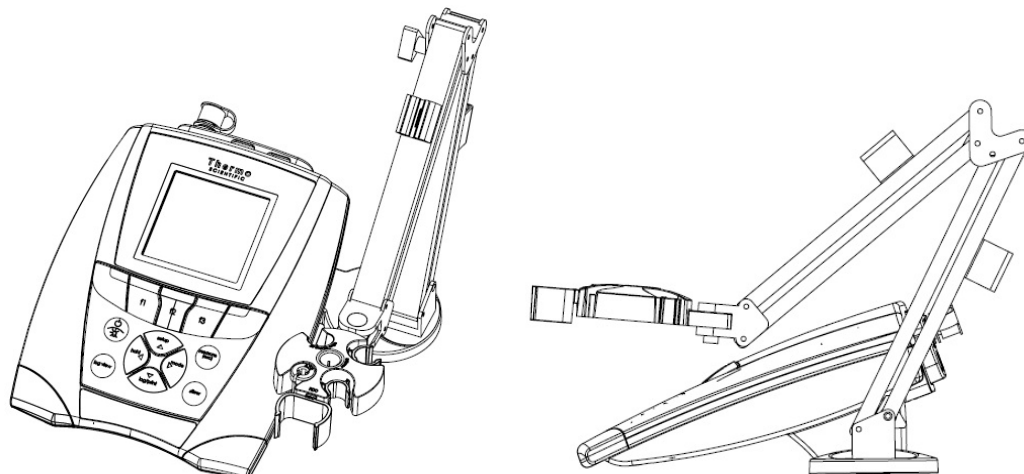

Figure 2:

Adjusting the Electrode Stand

Once the stand has been assembled, use the two wing-nuts highlighted in *Figure 3* to adjust the tension at each joint to restrict the movement forward and backward (lower wing-nut) and upward and downward (upper wing-nut).

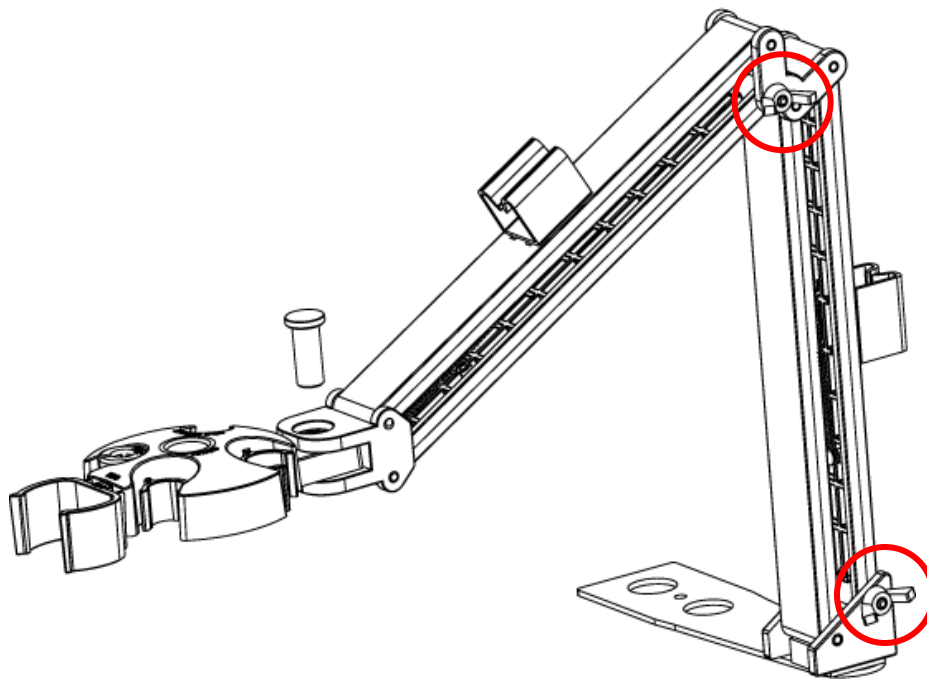

Figure 3:

Using the Electrode Holder

Place electrodes and probes into the stand for easy movement in and out of sample containers during calibration, sample measurement and electrode storage. Recommended electrode positions are shown in *Figure 4*. The electrode holder can also be ordered separately using Catalog Number STARA-ELHD.

Once electrodes have been placed into the stand, use the two cable management clips, highlighted in *Figure 1*, to organize the electrode cables.

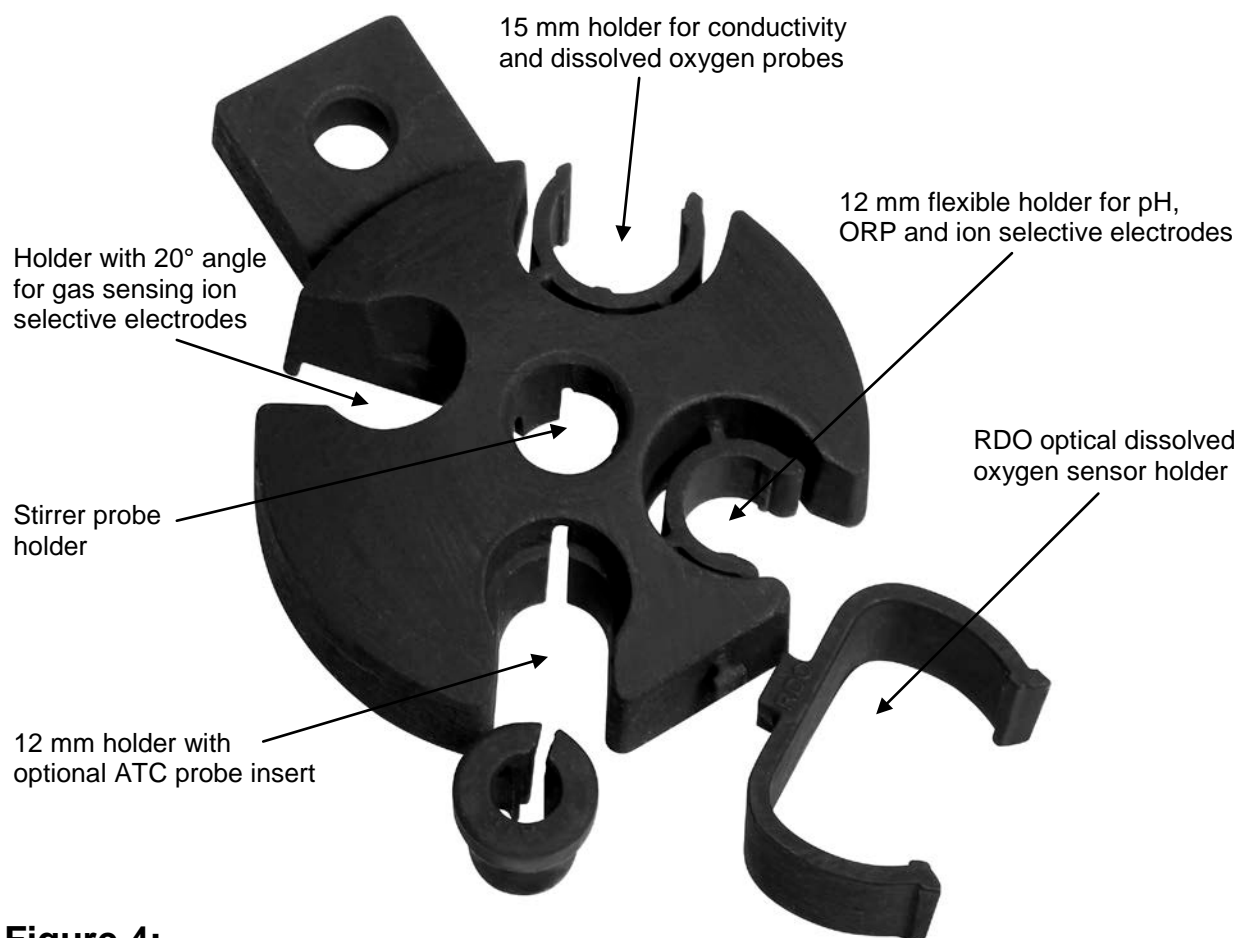

Figure 4:

Note: When placing electrodes into and out of the 12 mm flexible holder, always insert and remove electrodes vertically (up and down) in the holder. Never push or pull electrodes horizontally (side to side) in the holder, as this may damage the electrode.

Ordering Information

Cat. No.	Description
STARA-BEA	Orion Star A Series Benchtop Meter-Attachable Electrode Stand
STARA-HB	Orion Star A Series Weighted Base Only (does not include electrode arm or holder)
STARA-ELHD	Orion Star A Series Electrode Holder Only (does not include electrode arm or base)
VSTAR12	Orion Versa Star pH Benchtop Meter Kit, includes Versa Star meter, pH/mV module, ROSS Ultra Triode glass-body pH/ATC electrode, stirrer probe, solutions and stand
STARA2115	Orion Star A211 pH Benchtop Meter Kit, includes Star A211 meter, ROSS Ultra Triode glass-body pH/ATC electrode, solutions and stand
STARA1115	Orion Star A111 pH Benchtop Meter Kit, includes Star A111 meter, Triode glass-body pH/ATC electrode, solutions and stand
2115001	Orion Dual Star pH/ISE Dual Channel Benchtop Meter Kit, includes Dual Star meter, ROSS Ultra glass-body pH electrode, ATC probe, solutions and stand

For a complete listing of all available Thermo Scientific Orion meters, electrodes, solutions and accessories, please visit www.thermoscientific.com/water.

Contact Information

Thank you for your continued support of Thermo Scientific Orion products. Please visit www.thermoscientific.com/water to view the Orion meter, electrode, sensor and solution products and download product literature, user guides and software updates. To access additional product support files, please visit the [WLP Online Library](#).

For any questions or if you require assistance, contact our Technical Support Specialists:

Email wlp.techsupport@thermofisher.com

Within the United States, call 1-800-225-1480

Outside the United States, call +1-978-232-6000

For additional product information, contact your local authorized dealer, local Thermo Scientific Orion technical sales representative or contact us using the Water and Lab Products (WLP) contact information below.

© 2015 Thermo Fisher Scientific Inc. All rights reserved. All trademarks are the property of Thermo Fisher Scientific Inc. & its subsidiaries.

Water and Lab Products

North America
 Toll Free: 1-800-225-1480
 Tel: 1-978-232-6000
wlp.techsupport@thermofisher.com

Germany
 Tel: (49) 6184-90-6000
wlp.techsupport@thermofisher.com

China
 Tel: (86) 21-68654588
wlp.techsupport@thermofisher.com

India
 Tel: (91) 22-4157-8800
wlp.techsupport@thermofisher.com

Singapore
 Tel: (65) 6778-6876
wlp.techsupport@thermofisher.com

Japan
 Tel: (81) 045-453-9175
wlp.techsupport@thermofisher.com

Australia
 Tel: (613) 9757-4300
 In Australia: (1300) 735-295
wlp.techsupport@thermofisher.com